



GET ALL YOUR GEESE IN A ROW



# GET ALL YOUR GEESE IN A ROW



## PLEASE READ ALL INSTRUCTIONS BEFORE BEGINNING

Quilt measures approximately 39" X 43".

There are eighty 2" X 4" finished Flying Geese units, in a strippy set with 5 strip sets of 16 units. Each strip set is bordered by sashing.

The first border features the same fabric as the sashing, the second border features appliquéd block corners.

## HELPFUL HINTS

Make a legend with your fabrics & label to help when cutting.

Take time to cut accurately.

Use a scant 1/4" seam allowance. Make sure you establish an accurate seam allowance before starting to piece. Different fabrics and threads can affect your seam allowance from project to project. Use a 'wall' to help keep seam allowances consistent.

Always chain piece using a 'pig' (small fabric scrap) to keep work tidy, save time and thread.

Use a stiletto to keep seams nested together or pin on the diagonal just before the join point. Keep the seam on top pointing upwards to help nest seams together. Hold your finger against the side of the presser foot at the end of each unit to reduce seam from 'wowing' out.

Make sure to sew through the 'X' to keep points sharp.

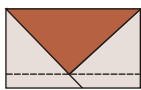

**Sew through the 'X'**

Press to set seams first, then open and press each piece. Don't saw the iron back and forth. Keep a light touch and a hot iron to get seams flat and square.

Always use a design surface to layout pieces in their proper place. Check for direction of directional prints while sewing.

Keep a copy of the block and top design handy to reference as needed.

Make up a sample block to test where trouble spots in seaming or pressing could be. Determine how to handle these prior to mass-producing blocks.

Approximate finished size:  
39" X 43" (.99m X 1.09m)

## SUPPLY LIST

<b>Fabric A</b>	Medium/Dark (print)	outer border	5/8 yd (.6 m)
<b>Fabric B</b>	Dark (dark red)	binding, sashing & 1 <sup>st</sup> border	1 1/8 yd (1 m)
<b>Fabric C</b>	Light (ivory)	background	7/8 yd (.8m)
<b>Fabric D</b>	Medium & Dark (prints)	large triangles in Flying Geese units	assorted prints/colours to equal 3/4 yd (.7m)
Fusible Web			10" square (25.5 cm)
Backing and batting to fit Black embroidery floss to blanket stitch appliqués			

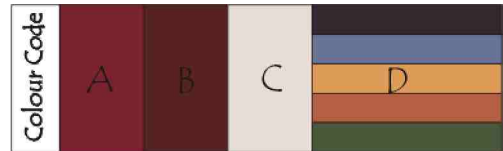

# GET ALL YOUR GEESE IN A ROW



## CUTTING INSTRUCTIONS (Yardage based on 42" width of fabric)

### Fabric A (MEDIUM/DARK - outer border)

Total Strips	Cut Size	Next Cut	Pattern section
4	4½" X 40" lengthwise grain	*****	outer borders

### Fabric B (DARK - binding, sashing & 1<sup>st</sup> border)

Total Strips	Cut Size	Next Cut	Pattern section
8	2½" X 42"	*****	sashings and 1 <sup>st</sup> border
5	2½" X 42"	*****	double fold ¾" finished binding

### Fabric C (LIGHT - background)

Total Strips	Cut Size	Next Cut	Pattern section
4	4½" X 4½"	*****	corner appliqué blocks in 2 <sup>nd</sup> border
4	7" X 42"	20 7" squares	Flying Geese small triangles or 'sky'

### Fabric D (MEDIUM/DARK - use assorted colours & prints)

Total Strips	Cut Size	Next Cut	Pattern section
3	5½" X 42"	20 5½" squares	Flying Geese large triangles or 'goose'

NOTE: scraps will be used for leaf and acorn appliqués

### FUSIBLE WEB

Total Strips	Cut Size	Next Cut	Pattern section
1	10" square	according to template layouts	for corner block appliqués

2. Mark a diagonal line through the middle of the squares (you will immediately know if the squares are centered) and pin to keep them from shifting.
3. Stitch using a scant ¼" seam on either side of the drawn line using a ¼" foot or draw the lines using a **Quick Quarter** tool.

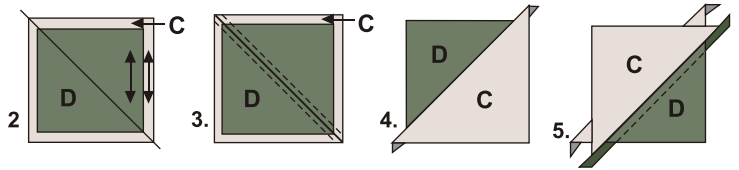

4. Press to set seam then cut apart on the marked line (corner to corner) and press to the larger triangle.
5. Lay both pieces right sides together, alternating sky and goose fabrics and aligning outside edges (things will look a bit strange here as the seam last sewn does not line up).
6. Draw another diagonal line through the middle of the squares, crossing the seam and pin OR use the **Quick Quarter** tool.
7. Stitch using a ¼" seam on either side of the drawn line or **Quick Quarter** lines.

8. Press to set seam.
9. Cut apart on the line, clip in the center of the seam so that when pressed to the larger triangle, both seams will lay flat and in the proper direction.

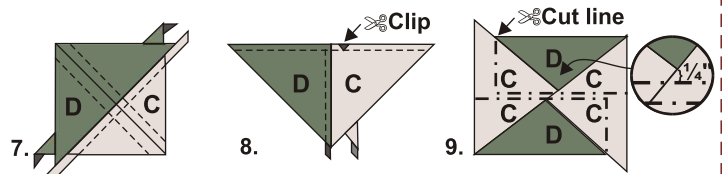

10. Trim out 2½" X 4½" units using the bias line on the 6½" square and making sure that there is a ¼" seam allowance at the top of the peak of the large triangle or use the **Flying Geese** ruler by Quilt In A Day®.

### PIECING INSTRUCTIONS

#### Make 80 - 2" X 4" finished Flying Geese units:

This technique is fast and accurate albeit a bit strange but definitely worth a try, it yields four very accurate FGU'S from only two squares.



Fabric D (Med/Dk)

1. Lay both squares right sides together (making sure that the grain lines match on all outside edges) with the larger of the squares on the bottom and the smaller square centered inside.

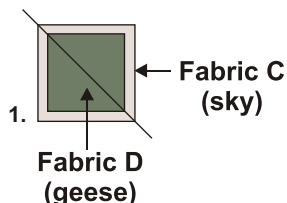

## GET ALL YOUR GEESE IN A ROW



### Putting it all together:

1. Set up your design wall. Assemble the rows by laying each unit on the design surface using the diagram as a guide. Check now to make sure you like the arrangement of colors.
2. Join flying geese units using a 1/4" seam allowance. Sew right through the 'X' to keep points sharp. Press seams down towards the point to keep 'X' visible when joining sashing to strip sets.
3. Measure all rows after pressing. Cut Fabric B 2 1/2" sashing strips to the average measurement. Pin mark center and quarter points on both row and sashing strips. Sew with sashing on the bottom so you can stitch right through the 'X' to keep points sharp. Press to sashing. Join all rows and sashing together. Press top.
4. Measure the top through the middle from top to bottom. Cut Fabric B border strips to this measurement. Press seams towards borders. Repeat for top and bottom borders by measuring through the middle side to side.
5. Prepare the corner appliqué blocks using the templates provided. Trace 4 small leaves, 4 large leaves and 12 acorns onto fusible web. Cut shapes out leaving about 1/8" around the traced lines. Following manufacturer's directions, fuse traced shapes to wrong side of Fabric D scraps. Cut out the shapes on the traced line. Arrange and fuse to Fabric C 4 1/2" squares. Arrange 2 acorns to one of the Flying Geese units in the quilt top. Appliqué using your favorite method by hand or machine.
6. Measure the top through the middle from top to bottom for the side borders and from side to side for the top and bottom borders. Cut Fabric A border strips to these measurements. Add the corner blocks to the top and bottom border strips. Stitch the side borders on first, and then add the top and bottom borders. Press seams towards borders.
7. Press the completed top. Measure to prepare batting and backing.
8. Quilting suggestions:  
Stitch in the ditch around 'geese', strip sets and borders.  
Quilt a simple cable design in the sashings and 1<sup>st</sup> border.  
Quilt a leaf design in the 2<sup>nd</sup> border or use the design motifs of your feature fabric or quilt straight lines perpendicular to the border.
9. Add label and sleeve.
10. Bind using a double fold 3/8" finished binding.

### TEMPLATES

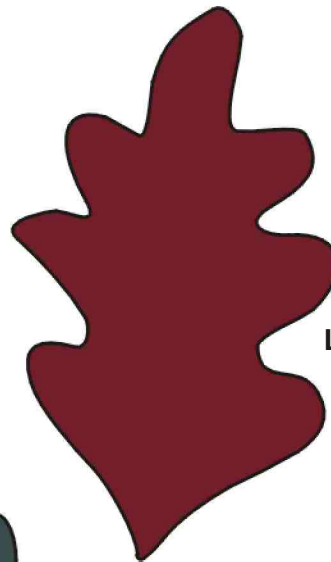

LARGE LEAF  
CUT 4

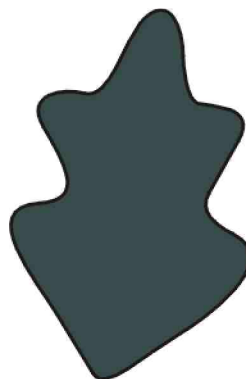

SMALL LEAF  
CUT 4



ACORN  
CUT 12

© Patchwork Schoolhouse 2005  
Joanne Middleton  
Box 699  
Bragg Creek, AB T0L 0K0  
CANADA  
Toll Free Phone 1-866-387-2824  
Toll Free Fax 1-866-211-8603  
[www.patchworkschoolhouse.com](http://www.patchworkschoolhouse.com)  
[joanne@patchworkschoolhouse.com](mailto:joanne@patchworkschoolhouse.com)

All contents of this pattern are protected by COPYRIGHT. Except as specifically permitted herein, no portion of the information in this pattern may be reproduced in any form, or by any means, without prior written permission from PATCHWORK SCHOOLHOUSE. Users are not permitted to modify, distribute, publish, transmit or create derivative works of any material found in this pattern for any public or commercial use.

We take great care to ensure that the information included in this pattern is complete, accurate & presented in good faith, but no warranty is provided nor results guaranteed. Having no control over the choices of materials or procedures used, neither the Designer nor PATCHWORK SCHOOLHOUSE shall have any liability to any person or entity with respect to any loss or damage caused directly or indirectly by the information contained in this pattern.